

CAT 3

FILING CABINETS AND STORAGE

COLLECTIONS

TAKE OFF

GENERAL INFORMATION

Description

- Storage on levelers with open compartment
- 19 7/8 x 12 x 21 1/8

Finish

- Low pressure laminate
- 1.5 mm thick ABS edge banding

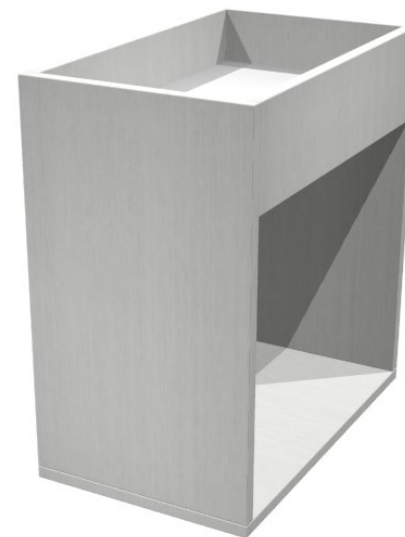

PLAN VIEW

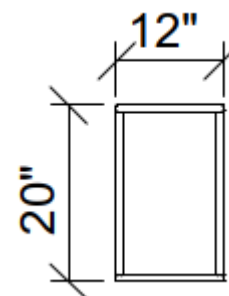

Laminates
Laminés

01

Specifications
Spécifications

This is
where ideas
take flight.
C'est ici
que des idées
décolleront.

01

Colors Couleurs	Finishes Finis	Codes
Black / Noir *	Dolomite	N
Carbon / Carbone	Aura	CB
Cayenne Maple / Érable de cayenne	Suede	CM
Charcoal / Fusain	Dolomite	F
Cherry / Cerisier	Suede	CH
Chestnut / Châtaigne	Supermat	CG
Dalia	Aura	DA
First Class / Première classe	Karisma	ST
Free Spirit / Esprit libre	Karisma	EL
Frost / Grès	Dolomite	A
Galaxy / Galaxie	Aura	GX
Ginger Root / Gingembre	Aura	GG
Honey / Miel	Suede	HO
Lago	Supermat	LA
Maritime Maple / Érable maritime	Supermat	EM
Moka	Supermat	PM
Sea Salt / Sel de mer	Aura	SM
Sesame / Sésame	Aura	SE
Sheer Beauty / Beauté naturelle	Karisma	BN
Tobacco Cherry / Cerisier tabac	Supermat	TC
White / Blanc	Dolomite	BW
Willow Grey / Gris saule **	Supermat	WG

* Black is not available as a TOP color. / Le noir n'est pas disponible en tant que couleur de SURFACE.

** Willow Grey in H.P.L. has a MAT finish, not supermat. / La couleur Gris saule en stratifié a un fini MAT, et non supermat.

artopex®

artopex®

Head office/Siège social
800 Vadnais, Granby QC
J2J 1A7 CANADA
T 450 378 0189/1 800 363 3040
F 450 378 9712
artopex.com

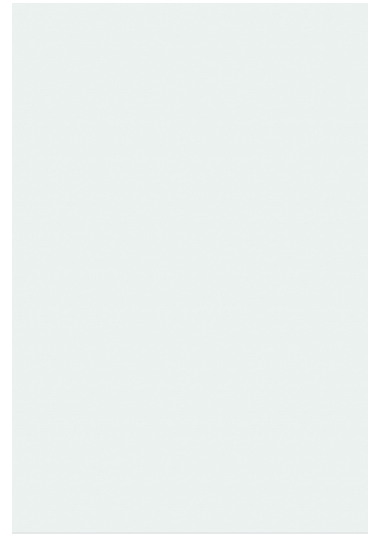

White / Blanc
BW



Frost / Grès
A

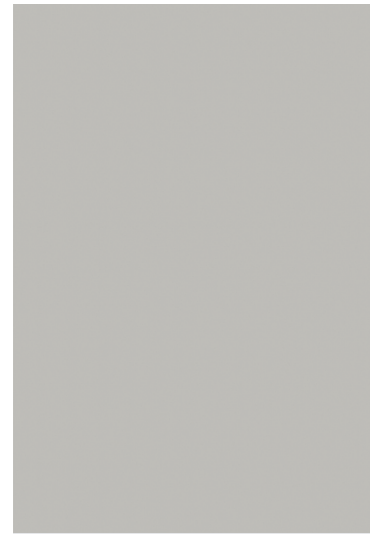

Willow Grey / Gris saule
WG



Lago
LA



Maritime Maple / Érable maritime
EM



Honey / Miel
HO



Tobacco Cherry / Cerisier tabac
TC



Cherry / Cerisier
CH



Sea Salt / Sel de mer
SM



Free Spirit / Esprit libre
EL



Sheer Beauty / Beauté naturelle
BN



Ginger Root / Gingembre
GG



First Class / Première classe
ST



Cayenne Maple / Érable de cayenne
CM



Galaxy / Galaxie
GX



Sesame / Sésame
SE



Moka
PM



Dalia
DA



Chestnut / Châtaigne
CG



Carbon / Carbone
CB

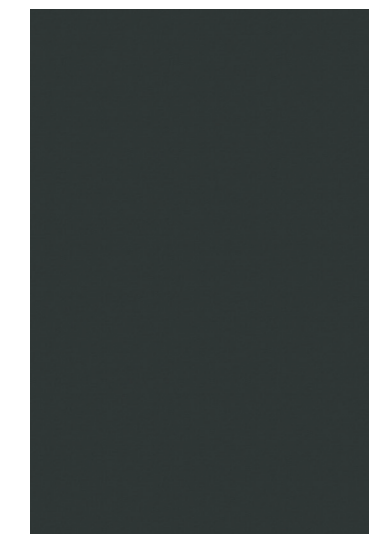

Charcoal / Fusain
F



Black / Noir
N